

APPLYING A SINGLE (CLUB SPEED) MARKER

▶ How to apply markers

! IMPORTANT! Before applying markers, thoroughly clean the face of all clubs with rubbing alcohol to ensure markers will adhere firmly.

A Remove the marker from the marker sheet using the clear peel tab. Avoid touching the marker with your finger.

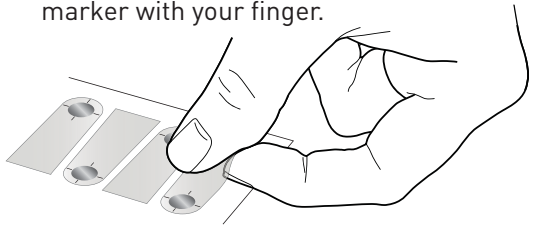

B Position the marker over the club face, cross-hair side up.

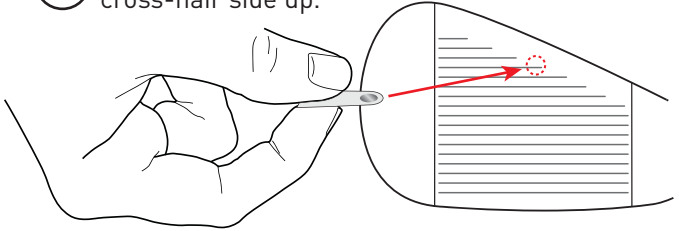

C Align the crosshairs on the marker with the score lines, and press firmly. Carefully peel the clear tab away from the applied marker, leaving only the marker on the face.

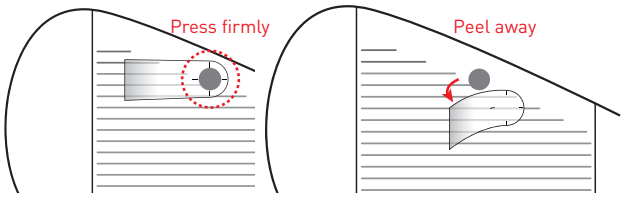

▶ Marker placement on all club types

For best results, place the marker high on the club face and as close to the horizontal center as possible.
*** One Dot Data analysis: Club Head speed, efficiency, path and angle of attack.**

▶ Drivers

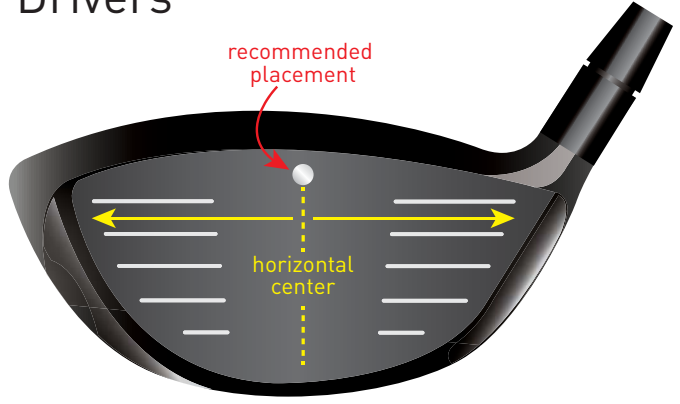

▶ Irons

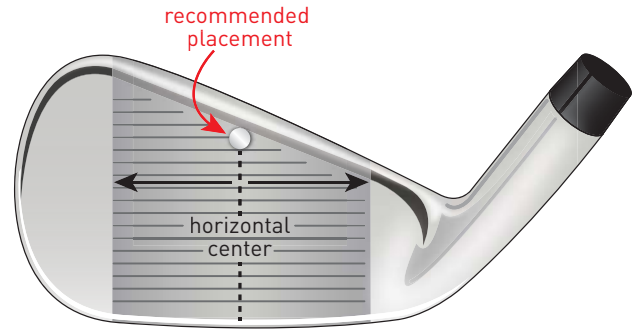

▶ Fairways/Hybrids

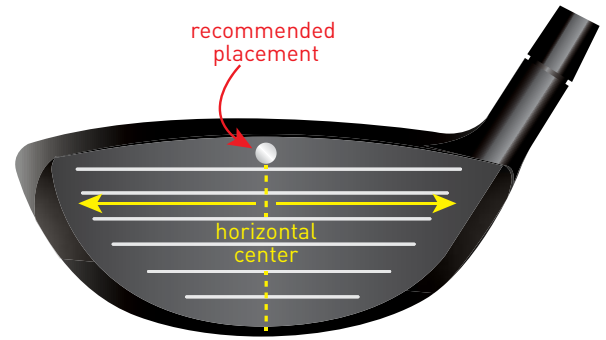

▶ Putters

